

KEY FEATURES

- Up to 2 hours fire rating
- 78mm Speedpanel Wall
- Simple Installation
- Australian Made
- Non Standard sizes available

GENERAL

The SpeedPanel / FYREPANEL is a screw fixed fire rated access panel with a laminated MDF or ACP face designed to meet the requirements of the BCA with FRL 120/120/120.

USES

The SpeedPanel / FYREPANEL is approved for installation in 78mm SPEEDPANEL walls of fire rated construction where integrity and insulation are required to be maintained to meet that of the building element requiring access through it. Eg: A FRL 120/120/120 SpeedPanel wall.

SIZES

The maximum in 78mm SPEEDPANEL walls is 1500x1000mm and provides fire rating from both directions.

Standard sizes are: 600 x 600mm &
 1200x600mm

Non standard sizes are available on request.

FIRE TEST DATA

The Fyreguard SpeedPanel / FYREPANEL has been tested and assessed to AS1530.4 to provide FRL's up to 120/120/120 in SPEEDPANEL walls. Please contact your nearest Fyreguard office for further information.

SPECIFICATION

Fyreguard SpeedPanel / FYREPANEL – Screw Fixed FRL 120/120/120 fire rated access hatch.
78mm Speedpanel Wall Application. PH. 07 55934955

INSTALLATION

Refer to this data sheet for installation instructions or contact your nearest Fyreguard office for assistance

MORE DATA

For data on the Fyreguard SpeedPanel / FYREPANEL Screw Fixed or any other fire rated access panels please do not hesitate to contact us. We reserve the right to change specifications without notice.





INSTALLATION INSTRUCTIONS

2 HOUR FIRE RATED SCREW FIXED FYREPANEL ACCESS PANELS FOR 78mm SPEEDPANEL WALLS.

1. Mark out and cut opening in the wall.
2. Trim opening on all 4 sides with 78x50x1.2mm C channel using 10 gauge steel self drilling screws, 100mm from each end and a maximum 250mm centres. NB: Align fixings with SpeedPanel joints where possible.
3. Fix SpeedPanels together at panel joints with 10 gauge screws at nominally 50mm above and below trimming channel, 400mm vertical centres above and below the opening and 400mm vertical centres in the next 2 panel joints on each side of the opening.
4. The reveal of the opening is to be lined with one layer of 13mm fire grade plasterboard using 8 gauge screws 50mm from the end in a row of 2 at 150mm centres and 20mm from each side
5. The face of the Speedpanel wall is to be lined with 2 layers of 13mm fire grade plasterboard which extends at least 100mm from the opening using 8 gauge screws 50mm from the end in rows of 2 at 150mm centres and 20mm from each side.
6. Unscrew fire rated panel from frame. Take note of the frame and panel as both are marked to ensure they correctly line up when the panel is screwed back into the frame.
7. Insert frame into opening and secure with self drilling 10 gauge steel screws in the holes provided in the frame. NB: The front face of the fire hatch is to be flush with the fire grade plasterboard. Ensure the gap is no greater than 3mm and the frame is packed to prevent buckling as the bolt holes will not line up with nuts if buckling occurs.
8. Caulk any gaps between the frame and the opening with fire rated sealant.
9. Screw panel into frame ensuring the correct sides line up with the nuts. Engage all screws before fully tightening.

TYPICAL FIXING DETAILS:

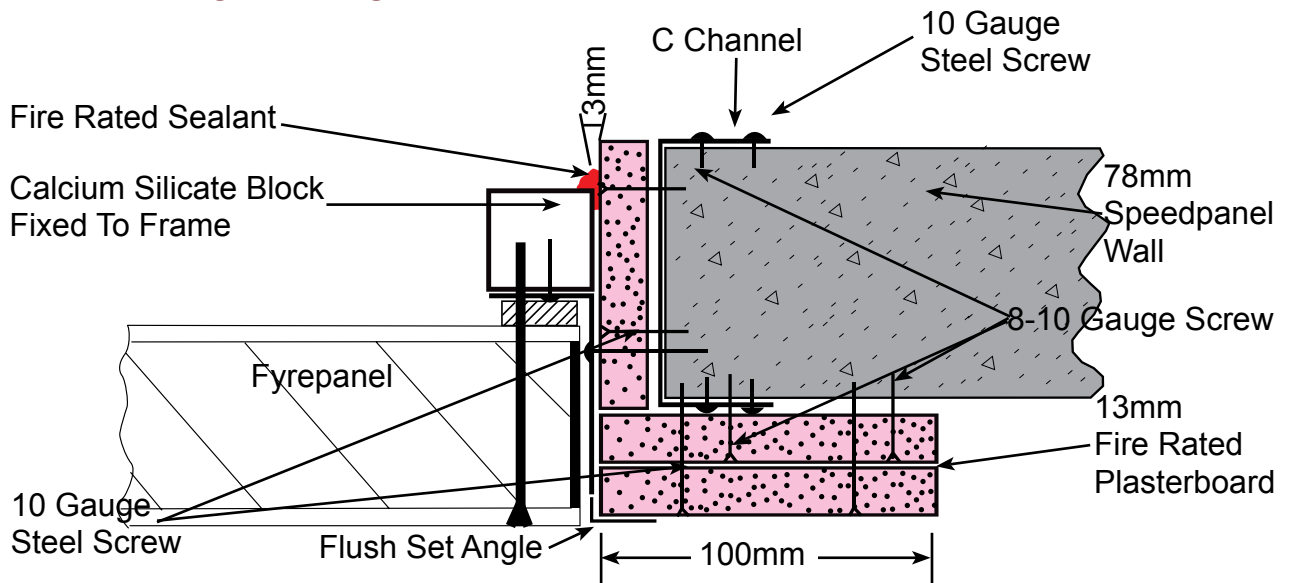

ALTERNATIVE FLANGE DETAILS:

