

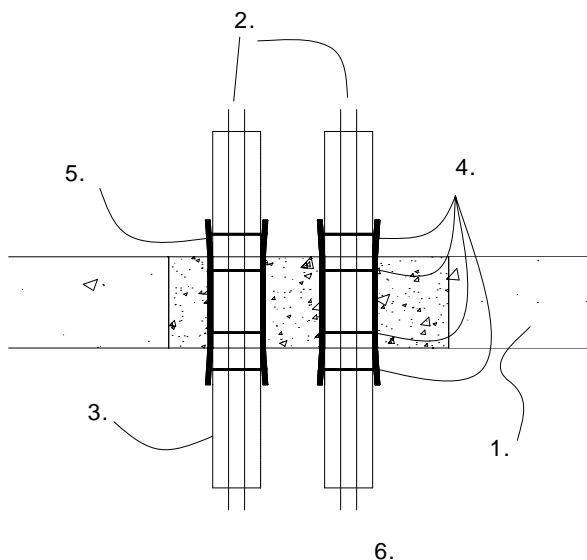

Gold Coast: 07 55934955
Brisbane: 07 38654422

PROMASEAL® FlexiWrap Installation Instructions

PROMASEAL® FlexiWrap is manufactured using PROMAT intumescent technology. Designed to provide fire resistance where combustible insulation is used as a thermal lagging around metal pipes. PROMASEAL® FlexiWrap has been tested for both wall and floor applications and when tested to AS1530.4-1997 and AS4072.1-1992 achieved an FRL of -/120/120. PROMASEAL® FlexiWrap is sold in sheet form 450mm x 2150mm. Refer test no. Wfra 41027.



1. Existing Slab
2. Copper pipe
3. Combustible Insulation
4. cable ties
5. PROMASEAL EasiWrap
6. Mortar backfill

For floor applications where groups of pipes with combustible lagging pass through a fire resistant floor, follow the following instructions.

Individually wrap each pipe with one layer of PROMASEAL® FlexiWrap. To ensure the wrap stays in place provide ties to 4 locations 1 each side of penetration and 2 within the penetration. Once wrapped the pipes can be backfilled with PROMASEAL® Fire Mortar.

For wall applications where groups of pipes with combustible lagging pass through a fire resistant wall, follow the following instructions.

Individually wrap each pipe (with combustible insulation) with one layer of PROMASEAL® FlexiWrap. Where the wall is of cavity construction this wrap should be encased within in a metal sleeve. To ensure the wrap stays in place provide ties to 4 locations 1 each side of penetration and 2 within the penetration. Once wrapped the pipes can be backfilled with other fire stopping methods, depending on the size of the opening. For close fitting openings this can be with PROMASEAL® Acrylic Sealant

Promat provides a wide range of systems for compartmentation, fire rated air and cable ducts, structural steel protection, fire stopping, glazing systems and partitions.

For assistance with any Pro Active Fire Protection problems contact your local distributor.

Phone 1800 30 20 20