



Fyreguard

PASSIVE FIRE PROTECTION

Brisbane : 07 3865 4422
Gold Coast : 07 5593 4955
Cairns / NQ : 0411 746 793
E : info@fyreguard.com

www.fyreguard.com

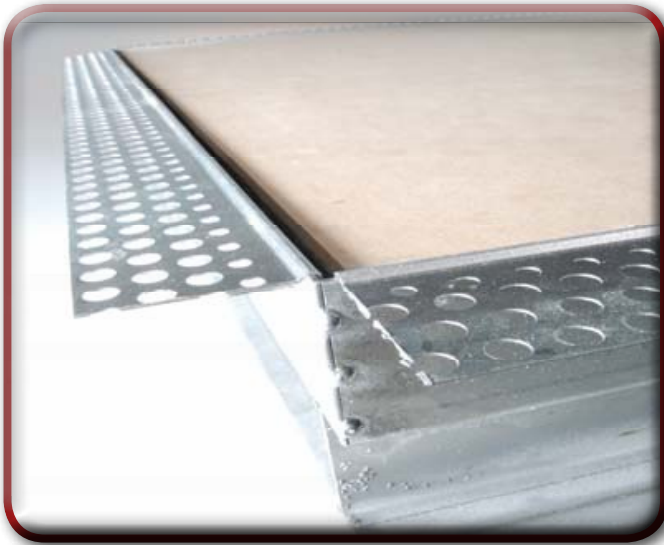

KEY FEATURES

- Up to 1 hour fire rating
- Wall and Ceilings
- Incipient Spread of Fire
- Simple installation
- Australian Made
- Non standard sizes available

GENERAL

The Fyreguard FYREHATCH is designed to provide a flush set or flanged fire rated access hatch for wall and ceiling applications where access is required. Maintaining up to a 1 hour fire rating. The FYREHATCH sits flush with the wall or ceiling lining and has concealed hinges to limit visual impact. The hatch is secured by a rim lock with a key provided or can be individually keyed for maximum security.

USES

The FYREHATCH is used in fire rated walls and ceilings for access to services or personnel access to roof spaces or for the maintenance of equipment.

SIZES

The maximum size for ceiling applications is 700x700mm and for wall application is 1200x700mm.

Stock sizes are: 300x300mm, 400x400mm
450x450mm, 530x530mm
600x600mm

Non standard sizes are available on request.

FIRE TEST DATA

The Fyreguard FYREHATCH-hinged has been tested and assessed to Australian Standard AS1530.4. to provide FRL 60/60/60; including resistance to the Incipient Spread of Fire. Please contact your nearest Fyreguard office for further information.

SPECIFICATION

Fyreguard FYREHATCH-Hinged FRL 60/60/60 Fire rated access hatch. Wall or Ceiling Application. PH. 07 55934955

INSTALLATION

Refer to this data sheet for installation instructions or contact the nearest Fyreguard office for assistance.

MORE DATA

For data on the Fyreguard FYREHATCH Hinged or any other fire rated access panels please do not hesitate to contact us. We reserve the right to change specifications without notice.

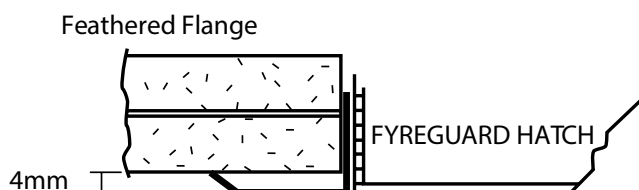
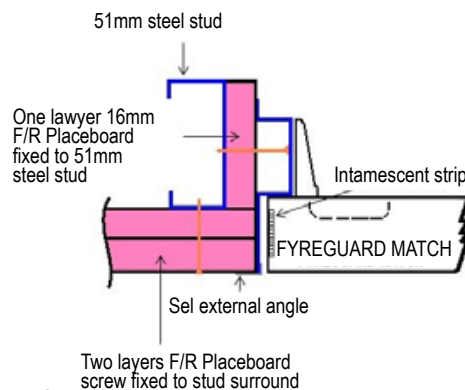

ACCESS HATCHES

NB: Fyreguard is not responsible if recipients of installation instructions, fire test reports or any relevant literature incorrectly interpret the contents or use products based on those interpretations.

FYREHATCH - HINGED FRL 60 / 60 / 60



INSTALLATION INSTRUCTIONS

1 HOUR FIRE RATED ACCESS PANELS CEILING FIXING DETAIL:

1. Mark out and cut opening in the ceiling.
2. Frame opening with steel studs or trimmers. Ensure studs or trimmers are connected to the ceiling joists or support structure and are set back 16mm. Line the studs or trimmers with 16mm fire rated board.
3. Match access panel to the now trimmed and lined ceiling opening.
4. Open the hatch/panel and secure frame to the joists or trimmers with steel screws on all 4 sides of the hatch in the holes provided.
5. For 'Set Bead' installations remove the hatch/panel and flush set. Return hatch/panel into the frame and test operation. Ensure the hinge screws are tightened.
6. While the hatch/panel is open apply fire rated mastic sealant to any gaps between the access panel frame and the inside reveal of the ceiling opening.
7. Close the hatch/panel and engage the lock and safety chain (if required).

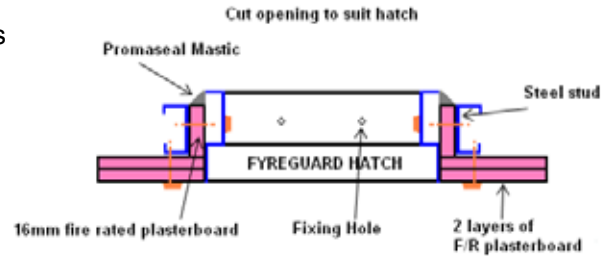

1 HOUR FIRE RATED ACCESS PANELS IN MASONRY WALL FIXING DETAIL :

1. Match Access Panel to wall opening.
2. Mark line at level of door frame in from face of opening. Open Access Panel door and secure frame surround through hole in to masonry with 60 x 6mm masonry anchors.
3. Seal around Access Panel frame surround and masonry using Promaseal Mastic.
4. Close Access Panel and engage lock.

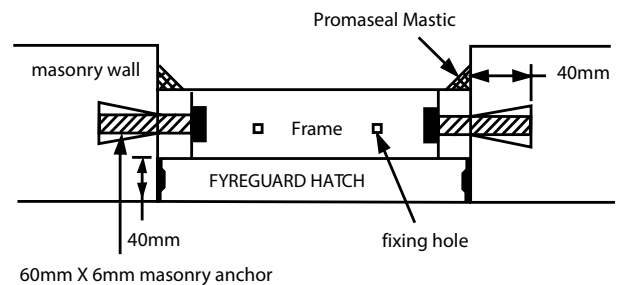

1 HOUR FIRE RATED ACCESS PANELS IN LIGHT WEIGHT WALL FIXING DETAIL:

1. Mark out and cut opening in the wall.
2. Frame opening with steel studs or trimmers. Ensure studs or trimmers are connected to the wall studs. Line the studs or trimmers with fire rated board of the same thickness as the fire exposed face of the wall.
3. Match access panel to the wall opening.
4. Open the hatch/panel and secure frame to the studs or trimmers with steel screws on all 4 sides of the hatch in the holes provided.
5. For 'Set Bead' installations remove the hatch/panel and flush set. Return hatch/panel into the frame and test operation. Ensure the hinge screws are tightened.
6. While the hatch/panel is open apply fire rated mastic sealant to any gaps between the access panel frame and the inside reveal of the wall opening.
7. Close the hatch/panel and engage the lock.

