



INSTALLATION INSTRUCTIONS: 2 HOUR - HP-FYREPANEL, 2 WAY, HEBEL WALL ACCESS PANEL

ACCESS HATCHES

- M 0-2mm mm
- T m H 70mm N m.1.2mm A .A 14-10 mm H 100mm m A m 100mm
- T mm 1 mm .0 1 mm m m m 100mm 1 mm FR .A .F 10mm

ARCHITECTURAL DETAIL

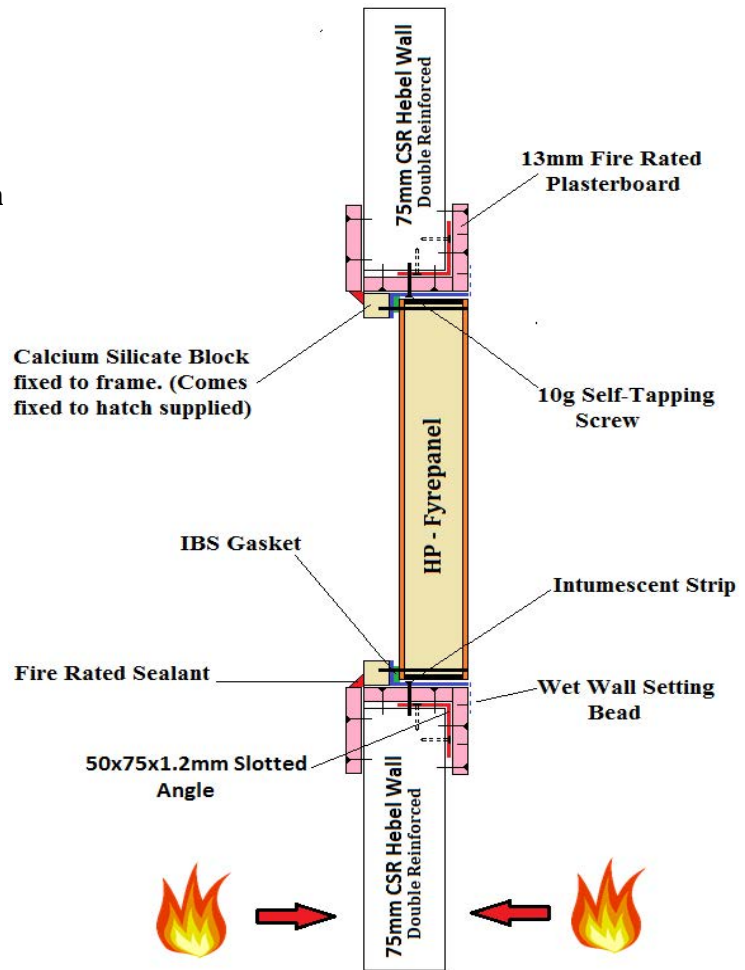
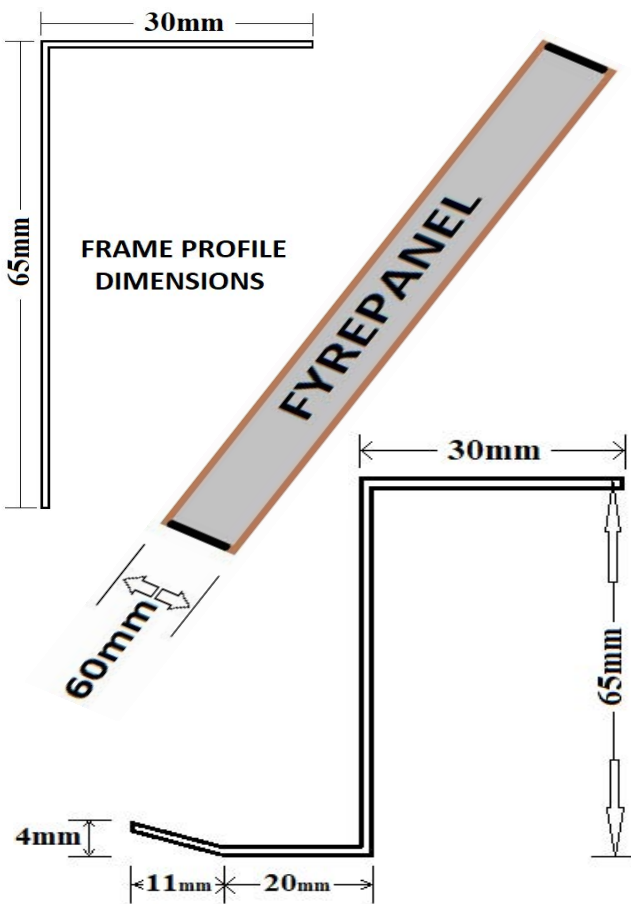

- R m m m 10 m
- NB: E m m m m
- T / . E m
- W / m m

Insert hatch/panel into frame ensuring the correct sides line up – refer to identification points on frame and hatch/panel. Engage all panel screws before fully tightening.

NB: ALL FYREGUARD FIRE RATED ACCESS HATCHES ARE LABELED FOR EASE OF COMPLIANCE AND MAINTAINENCE INSPECTIONS. LABELING IS IN ACCORDANCEWITH FPAA GOOD PRACTICE GUIDE AND AS4072.1



INSTALLATION INSTRUCTIONS: 2 HOUR - HP-FYREPANEL, 2 WAY, HEBEL WALL ACCESS PANEL

1. Mark out and cut opening in wall approximately 30-32mm larger than hatch frame to allow for trimming of opening.
2. Trim opening in Hebel with 75x50mm galvanised Nom.1.2mm Angle. Angle to be fixed with 14-10 x 65mm Hex head screws at 100mm centres, fixings to start no more than 100mm from either end of Angle.
3. Trimmed opening is to be lined with one layer of 13mm fire rated plasterboard using 8g steel screws. One layer of 13mm fire rated plasterboard is also to be installed to each face of the wall and extend a minimum of 100mm from the opening. Alternatively two layers of 13mm FR plasterboard can be installed to side of wall which hatch finishes flush with. Fixings to be in two rows at 150mm centres.

ARCHITECTURAL DETAIL

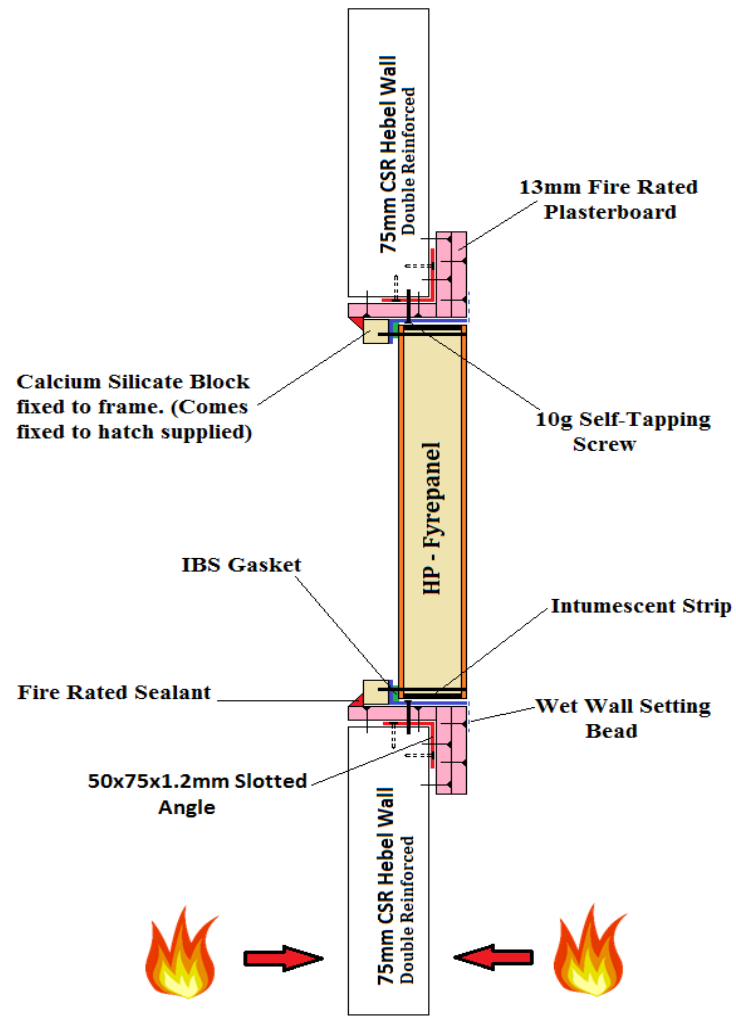
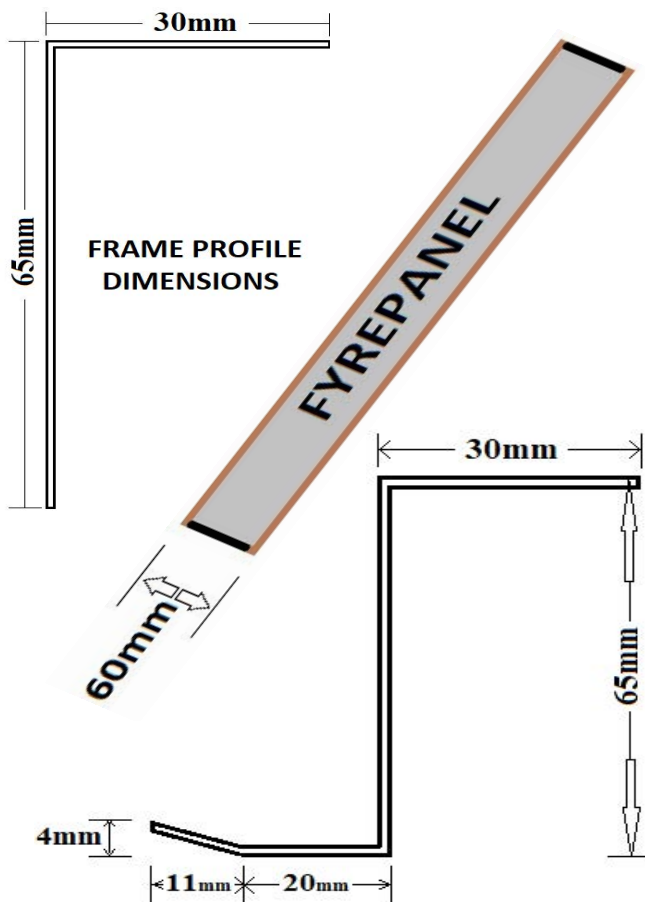

4. Remove panel from frame and install frame into opening using predrilled holes and 10g steel screws. NB: Ensure the frame is temporarily packed out before tightening screws to prevent the frame from distorting. The hatch/panel bolts will not line up with the nuts if distortion occurs. Ensure to remove temporary packers.
5. While the hatch/panel is open apply fire rated mastic sealant to any gaps between the access panel frame and the inside reveal of the opening.
6. Insert hatch/panel into frame ensuring the correct sides line up – refer to identification points on frame and hatch/panel. Engage all panel screws before fully tightening.

NB: ALL FYREGUARD FIRE RATED ACCESS HATCHES ARE LABELED FOR EASE OF COMPLIANCE AND MAINTAINENCE INSPECTIONS. LABELING IS IN ACCORDANCE WITH FPA GOOD PRACTICE GUIDE AND AS4072.1

FYREGUARD HP - FYREPANEL FRL -/120/120