

Installation Method

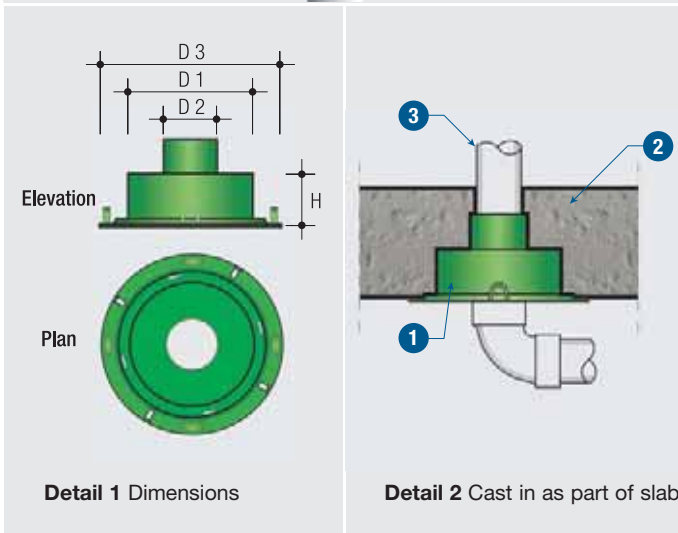

Detail 1 Dimensions

Detail 2 Cast in as part of slab

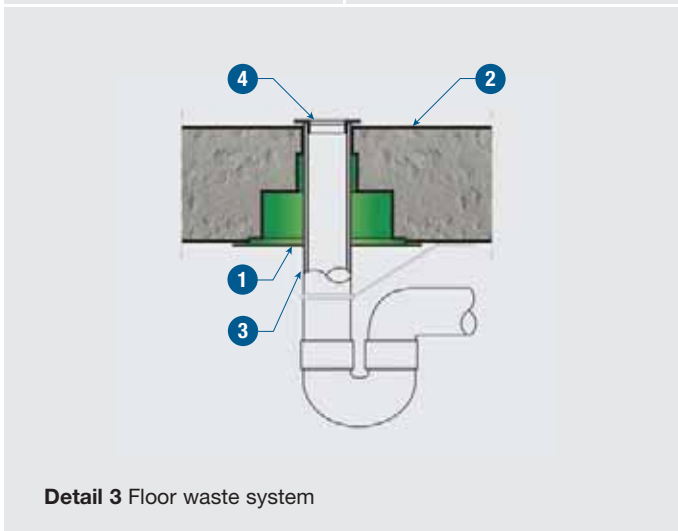

Detail 3 Floor waste system

PROMASEAL[®] Green Cast-In Collars have been tested in floor constructions for up to 3 hours. Tests were carried out using the procedures and criteria of AS 1530: Part 4 and AS 4072: Part 1.

The results are reported by approved testing laboratories.

PROMASEAL[®] Green Cast-In Collars help prevent the passage of smoke, toxic gases and fire through gaps in compartment floors caused by the collapse and melting of combustible services in the event of a fire. For installation of collars in permanent form work and thin floor slabs (<120mm) applications always contact Promat.

TECHNICAL DATA

- 1 PROMASEAL[®] Green Cast-In Collar
- 2 Concrete floor, with fire resistance equal or higher than the collar
- 3 Plastic piping
- 4 Floor waste grille

PROMASEAL[®] Green Cast-In Collar size ranges from pipe OD 43mm to 110mm for fire ratings up to 3 hours with uPVC and HDPE pipe. Different collars designs have FRL s ranging up to 4 hours depending on the application. If the user is unsure of their requirement, please contact Promat.

Installation

Place the collar onto the formwork. Secure the collar into position with 20mm x 3mm flat head clouts, nailed through the notches provided. DO NOT SKEW THE NAILS.

Insert a pipe section through the collar so that the end of the pipe sits flat of the formwork, ensuring the top of the pipe is higher than the finished slab depth.

Ensure the pipe section remains in place and plumb during the concrete pour and immediately afterwards.

After the formwork is stripped, the casting pipe may be knocked out of the collar and replaced with the requisite pipe section where applicable.

Dimensions Guide

Code No.	Pipe nom. size (mm)	Body (mm)			Flange plate
		H	D 1	D 2	D 3
Green 40	40	49 + 30*	115	43	160
Green 50	50	49 + 30*	115	56	160
Green 65	65	49 + 20*	115	69	160
Green 80	80	60 + 20*	163	83	210
Green 100	100	60 + 20*	163	110	210

*Additional height of upright pipe grip

Floor Waste Systems

Collars used for floor waste are available in various models and the type used depends on the Certification required for the building.

All floor waste systems have been tested with uPVC pipe in accordance with AS 1530: Part 4 and the appropriate provisions of AS 4072: Part 1.

FWL Cast-in collars provide fully insulated systems.

Integrity only systems and Alternate solutions are also available (all in accordance with the provisions of the BCA).

Retrofit systems are available which provide fully insulated, Integrity only and Alternate solutions (all in accordance with the provisions of the BCA).